

RoboReel Triplex

Aircraft Dynamics Corporation - Utility Division

418 East Kiracofe Avenue, Elida, Ohio 45807

Tel: 800-874-4702 - 419-331-0371

Cat No. 5478

www.aircraftdynamics.com



RoboReel Triplex Reel - designed for lineman to provide an easy and safe means to unwind and rewind cumbersome wire and cable. Extremely rugged, all-weather heavy-duty reel. Made of steel and zinc coated, the RoboReel Triplex has eight adjustable arms that allow for a quick, easy and secure means to load, unwind and rewind various coils sizes and diameters. Coils can be simply rolled into the stand and clamped into place with the adjustable arms. Wire is easily pulled or rewound through a "smooth" guide. Reel can be installed on a floor or wall.

- **Eight Adjustable Arms.**
- **Accepts coils with outside dia. from 26" - 32" (inside dia 14" - 20").**
- **Coil widths can be up to 10-1/4."**
- **Weight:58 lbs.**

Accepts coils with
Outside dia. 26" - 32"

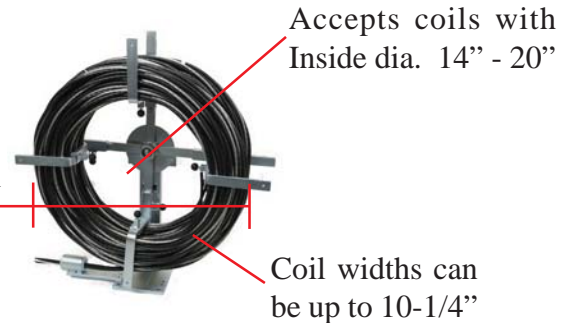

I. Unbox Roboreel and Hooks, Install Wire Guide & Mount RoboReel

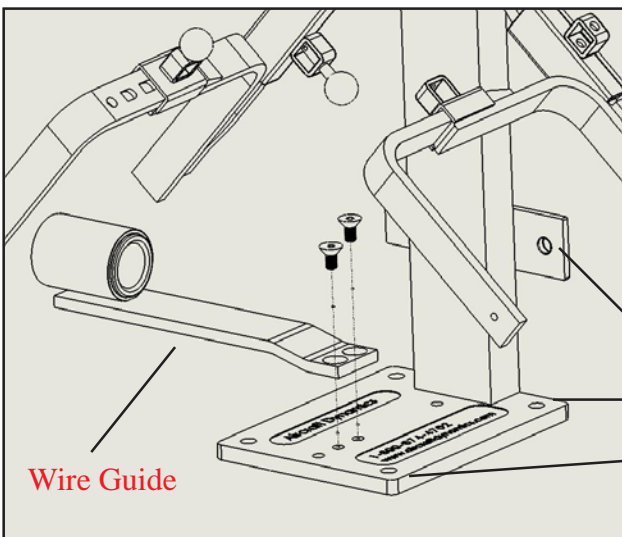

For shipping, Wire Guide is not attached to the base. **INSTALL SECURELY IN CORRECT POSITION AS NEEDED FOR DRIVER OR PASSENGER SIDE MOUNTING.**

MOUNT ROBOREEL USING THE HOLES ON THE BASE AND/OR SIDE OF ROBOREEL TO THE DESIRED LOCATION ON YOUR VEHICLE.

II. Installing Triplex Coil and Adjusting the Hooks

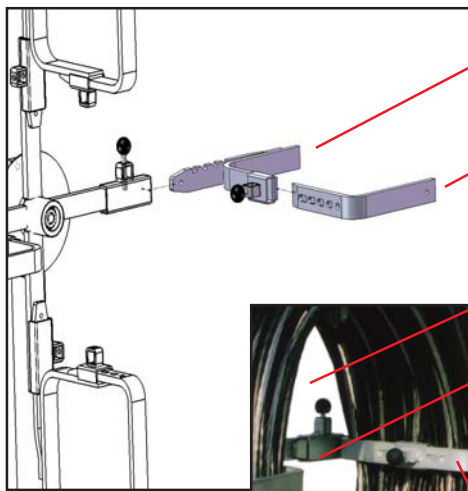

Inside Hooks

Outside Hooks

- 1) MEASURE THE *INSIDE* DIAMETER OF THE COIL.
- 2) INSTALL THE INSIDE HOOKS STOPPING AT THE NOTCH THAT IS CLOSEST BUT IS NOT SMALLER THAN THE INSIDE COIL DIAMETER.

NOTE: (*THE INSIDE HOOKS SHOULD BE EQUALLY SPACED FROM THE CENTER HUB.*)

NOTE: (*FOR EASIER COIL INSTALLATION TEMPORALLY PUT THE BOTTOM HOOK IN THE SMALLEST DIAMETER NOTCH.*)

DO NOT REMOVE COIL MANUFACTURER'S BANDING UNTIL YOU HAVE REACHED STEP 5!

- 3) INSTALL OUTSIDE HOOKS. POSITION HOOKS SO THEY ARE SNUG AGAINST THE COIL

- 4) MOVE THE BOTTOM HOOK OUT UNTIL IT IS SNUG AGAINST THE COIL

- 5) YOU CAN NOW REMOVE THE COIL MANUFACTURER'S BANDING AND FEED THE WIRE THROUGH THE CABLE GUIDE.



III. Proper Braking Tension

ADJUST BRAKE TENSION FOR PROPER BRAKING TENSION. FOR PROPER TENSION ADJUSTMENT, LOOSEN THE JAM NUT AND USE CHANNEL LOCK PLIERS.

NOTE: TENSION MUST BE APPLIED VIA THE BRAKING SYSTEM FOR PROPER OPERATION. (IF THE BRAKE IS LOOSE THE ROBOREEL WILL CONTINUE TO SPIN AFTER YOU STOP PULLING THE WIRE.) - **PROPER TENSION MUST BE APPLIED TO AVOID FREE SPINNING OF ROBOREEL** - FROM TIME-TO-TIME TENSION MAY NEED TO BE READJUSTED.

